



LAUNDRY

WASHER EXTRACTOR PRC-14



AVAILABLE OPTIONS

- Connection to detergent pumps
- Water recovery system: The water from the last rinse is used in the first cycle of the next immediate program
- Drain pump &/or water inlet
- Gas, steam, or electric power

STANDARD FEATURES

- Top, frontal, and side panels in stainless steel AISI 304
- Ground fixed with chemical bolts (Supplied)
- Drum and outer drum in stainless steel AISI 304
- IM 8: An intuitive touch screen computer with up to 200 programs in 15 different languages. Also equipped with a large LCD screen making it easy to understand, use, and program with simple icons and photos
- IM 8 allows the user to customize wash cycles
- Half load programs with automatic reduction of washing level and detergent dosing available as well
- GSM remote assistance: Each machine is equipped with a GSM module to allow for remote diagnosis and service
- USB port: Allows for file downloads from machine to PC or from machine to machine
- Motorized door lock: An automatic door lock that is activated at the start of the program
- Ergonomics: The display is tilted to avoid any reflection on the screen, It's large door diameter makes the loading/unloading easier

WASHER EXTRACTOR PRC-14

Technical Data

Washer capacity	14 Kg
Drum dimensions (ØxP)	700 mm x 365 mm (380 mm load Ø)
Wash speed	37 RPM (470 RPM Low speed)
Electric heating element	3 x 3 Kw
Total electric power (Consumption)	11 Kw (5 Kwh)
G-factor	86
Drum volume	140L
Water consumption	234L (52L Low level) (59L High level)
Steam consumption (Max. pressure)	9Kg (4.5 Bar) *1.5kW total power
Machine dimensions (LxWxH)	857 mm x 880 mm x 1314 mm
Packing dimensions (LxWxH)	1150 mm x 1000 mm x 1640 mm
Gross weight / Net weight	305 Kg / 266 Kg

Detail & Dimensions

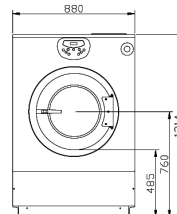
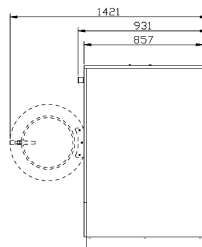
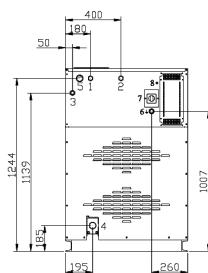

BETON BASE

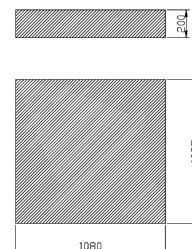

- 1 - Cold water inlet 3/4" - Press 0,5 ÷ 10 bar
- 2 - Hot water inlet 3/4" - Press 0,5 ÷ 10 bar
- 3 - Steam inlet 3/4"
- 4 - Drain Ø50 mm
- 5 - Bleed
- 6 - Electrical power
- 7 - External connections
- 8 - Fuse

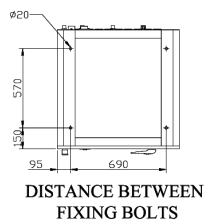

DISTANCE BETWEEN
FIXING BOLTS

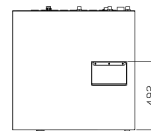

FRONT



As continued product improvement is a policy of Powerline, specifications are subject to change without notice.



POWERLINE EQUIPMENT COMPANY

Pulaski Street, Norwalk, CT 06851 USA. Tel: 203-847 2357 Fax: 203-847 6480

www.powerlinelaundry.com