



LAUNDRY

WASHER EXTRACTOR SA-300



AVAILABLE OPTIONS

- Tilt one way for easy unloading
- Tilt two way for loading and unloading
- Direct steam heating
- Stainless steel front panel
- Additional inlet(s) water or steam
- Air cushion suspension system
- Water reuse inlet and drain
- EMI filter for CE
- PC programming kit

STANDARD FEATURES

- Heavy duty frame
- Stainless steel panels
- All wetted parts are stainless (304)
- Air operated door gasket
- Large door opening and reliable door lock make loading and unloading fast with the 180 degree flexibility of the door. The silicon door gasket seals to the shell every time without fail
- 5 compartment supply dispensers for both liquid and detergent. They are automatically flushed during each cycle
- 6 external liquid supply connections
- Fully enclosed heavy duty drive motor
- Bearings outside the wash solution
- Heavy duty suspension system
- 250G aided extraction speed allows for a save in money and time, minimizing
- 3 degree leanback for lower bearing loads
- Standard voltages: 380-415/50/3, 208-240/60/3 or 440-460/60/3
- The PUNP microprocessor touch screen control center is easy to use and equipped with all needed features to ensure maximum productivity at the lowest cost of operation. The easily programmed 4 language display controls temperature, water levels, speed, and maintenance intervals.
- Single motor inverter driven

WASHER EXTRACTOR SA-300

Technical Data

Washer capacity	136.08 Kg 300 lbs
Drum dimensions (Ø x P)	1321 mm x 965 mm * 1.32m ³ Volume
Door dimensions (Ø x h)	1009.7 mm x 925 mm
Motor	22 kW 30 HP
Wash speed	33 RPM
Extraction speed (Immediate extraction)	435 RPM (#1) 545 RPM (#2) 660 RPM (#3) (330 RPM)
Drain system	101.6 mm outlet 63.5 mm overflow size 1(2) drain outlet(s)
Chemical supply system	5 dry chemical compartments & liquid supply connections (.5")
Basket volume	1180L 1.18m ³
Inlets	5/4" (Water) 1" (Steam) 2 water inlets 1 steam
Machine dimensions (LxWxH)	2362 mm x 1886 mm x 2159 mm
Net weight	3977 Kg
Shipping weight	4090 Kg

Detail & Dimensions

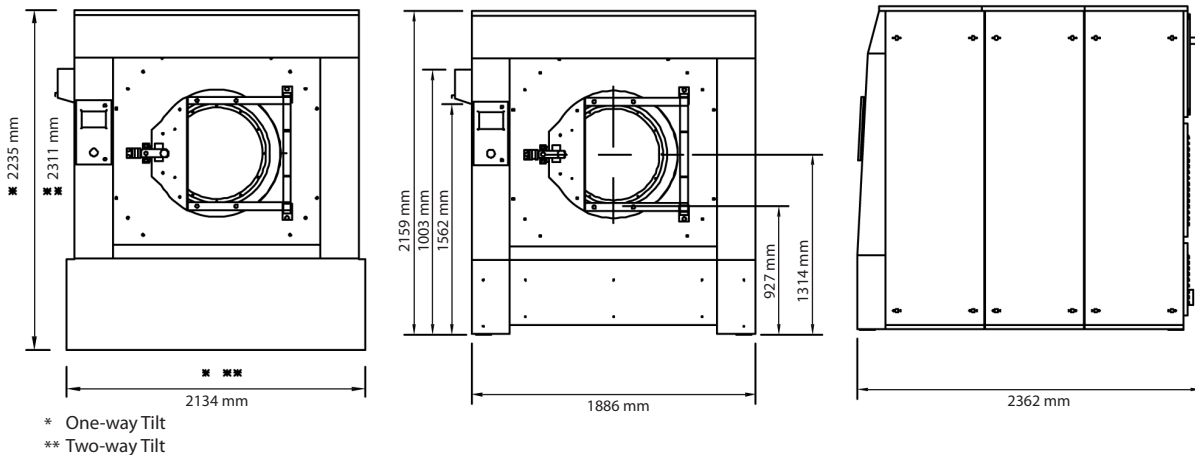

As continued product improvement is a policy of Powerline, specifications are subject to change without notice.



POWERLINE EQUIPMENT COMPANY

Pulaski Street, Norwalk, CT 06851 USA. Tel: 203-847 2357 Fax: 203-847 6480

www.powerlinelaundry.com